

LEGAL DESCRIPTION:
PARCEL "A", "PARAMOUNT PARK LLC", ACCORDING TO THE
PLAT THEREOF, AS RECORDED IN PLAT BOOK 183, PAGE 371,
OF THE PUBLIC RECORDS OF BROWARD COUNTY, FLORIDA.

LEGEND

- EXISTING WATER MAIN
- PROPOSED WATER MAIN
- EXISTING SEWER MAIN
- PROPOSED SEWER MAIN
- EXISTING DRAINAGE
- PROPOSED DRAINAGE
- PROPOSED PAVEMENT
- EXISTING PAVEMENT
- EXISTING PAVEMENT TO BE REMOVED
- EXISTING UTILITIES TO BE REMOVED
- EXISTING ELEVATIONS
- PROPOSED ELEVATIONS
- DIRECTION OF RUN-OFF
- EXISTING TEE
- PROPOSED TEE
- EXISTING CATCH BASIN
- PROPOSED CATCH BASIN
- EXISTING VALVE
- PROPOSED VALVE
- EXISTING MANHOLE
- PROPOSED MANHOLE
- EXISTING FIRE HYDRANT
- PROPOSED FIRE HYDRANT
- DENOTES BACTERIOLOGICAL SAMPLING POINTS

Robert C Smith
Digitally signed by Robert C Smith
Date: 2022.03.14 17:06:30 -04'00'

This item has been digitally signed and sealed by Robert C Smith, P.E., on March 14, 2022. Printed copies of this document are not considered signed and sealed and the signature must be verified on any electronic copies.

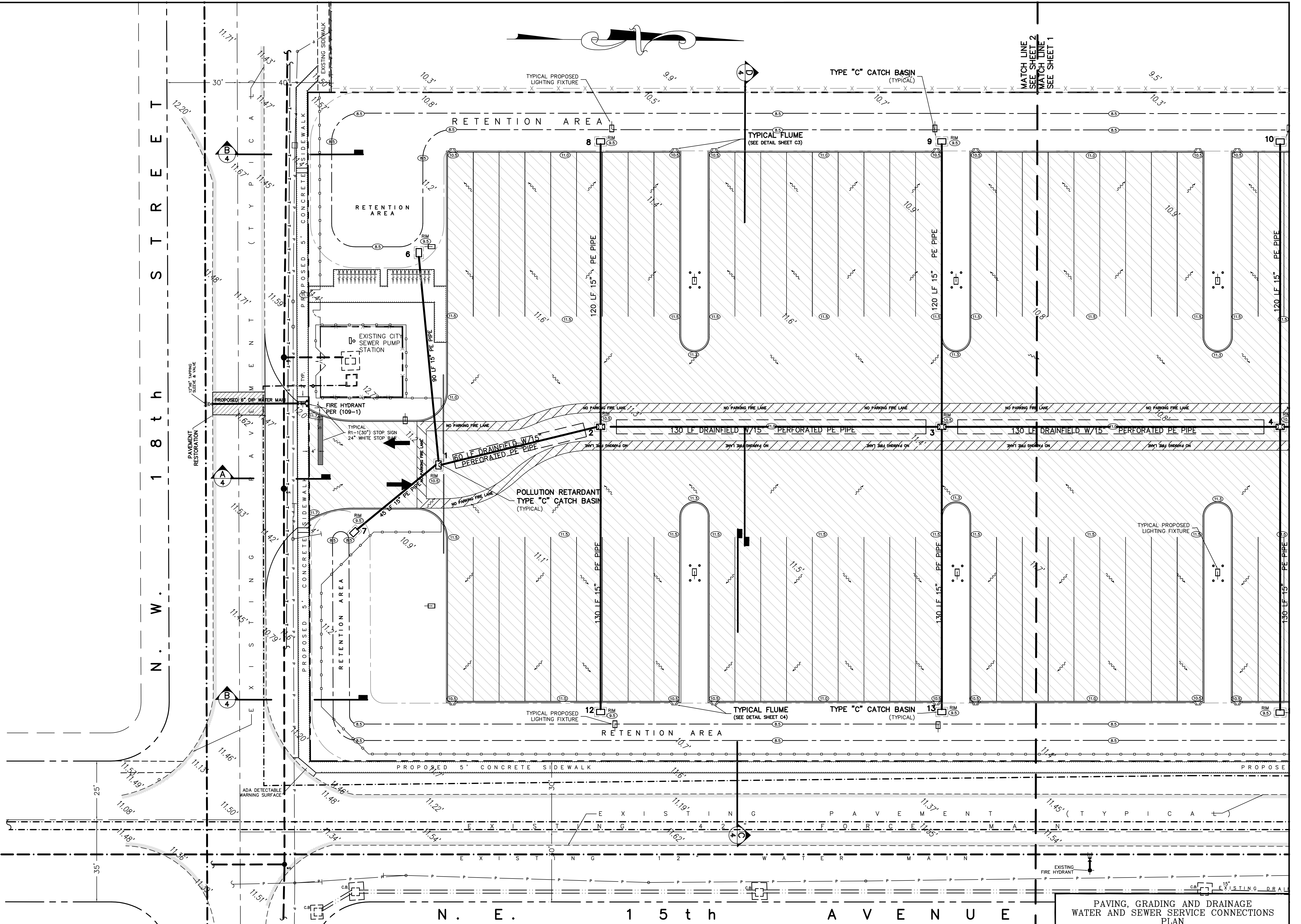

PLAN SCALE: 1" = 20'

- NOTES:**
1. THE ELEVATIONS SHOWN ARE BASED ON THE NORTH AMERICAN VERTICAL DATUM - NAVD 1988
 2. PROPERTY LIES IN FLOOD ZONE X - AUG. 18, 2014
 3. THIS PLAN IS FOR PAVING AND DRAINAGE ELEVATIONS & DETAILS, AND UTILITIES LOCATIONS ONLY. FOR EXACT LAY-OUT, SEE SITE PLAN PREPARED BY ARCHITECT.
 4. NO LANDSCAPE MATERIAL (OTHER THAN SOD) SHALL BE PLACED WITHIN (5') FIVE FEET OF ANY CITY OWNED UTILITY LINES.
 5. ALL EXISTING WATER AND SEWER SERVICES NOT UTILIZED TO BE REMOVED UP TO THE MAIN

6. Please note on civil plan C1 & C2 Water & Sewer Connection, that any existing water and/or sewer connection to the subject lots not utilized must be cut and capped at the water main if a water service and cut out and sleeved if a sewer lateral.
- "How to retire old laterals"
- If the existing main is clay pipe and has a GIPP liner currently installed: (Install a sectional liner in the main over the old lateral thus eliminating the lateral)
- If the existing main is clay pipe: (Dig down cut old clay pipe, sleeve back in with PVC and city approved couplings)
- If the existing main is clay pipe and you are required to retire multiple laterals for a project (it may be cheaper for the contractor to install a city approved GIPP liner from manhole to manhole and not cut out the laterals that they are retiring)
- If the existing main is PVC pipe: (Remove the lateral pipe from the PVC Wye Fitting and install a plug into the Wye. Install a green locating marking ball at the lateral locating, no deeper than 4 ft. below grade)



PAVING, GRADING AND DRAINAGE WATER AND SEWER SERVICE CONNECTIONS PLAN			
SNL IOV POMPANO BEACH LLC CHICAGO, ILLINOIS			
IOV SPEC - POMPANO BEACH			
JOHN B. SMITH ENGINEERS, INC. 1457 N.E. 4th AVENUE FOR POMPANO BEACH, FLORIDA 33064 PHONE: (904) 755-4177 CERTIFICATE OF AUTHORIZATION No. 16			
DESIGN R.C.S.	DRAWN RCS	DATE SEPT., 2022	FILE 2-144
Approved By: Robert C. Smith, P.E. Registered Engineer No. 31177			

PZ20-120900240
4/20/2022